

Arrival Procedures:

6:30am to 7:15am

Before School Care (Innovation Learning) drop off at Dyer Hall entrance (C). Please use the West Parking Lot.

7:30am – 7:50am

- Drop off is along sidewalk from (A) Main Entrance to (E) Stage Doors. Please pull as far up to Flag as possible. Do not stop at the (D) Boehm Doors
- Students should get out of car on passenger side, parents stay in car. If student needs help exiting car, roll down passenger window and unlock doors. A staff member will assist them.

7:50am

Students should be dropped off at (A) Main Entrance only

8:05am

Students are tardy and doors are locked. You must walk your student in and sign them in.

Leave right late open for cars going to Main Church

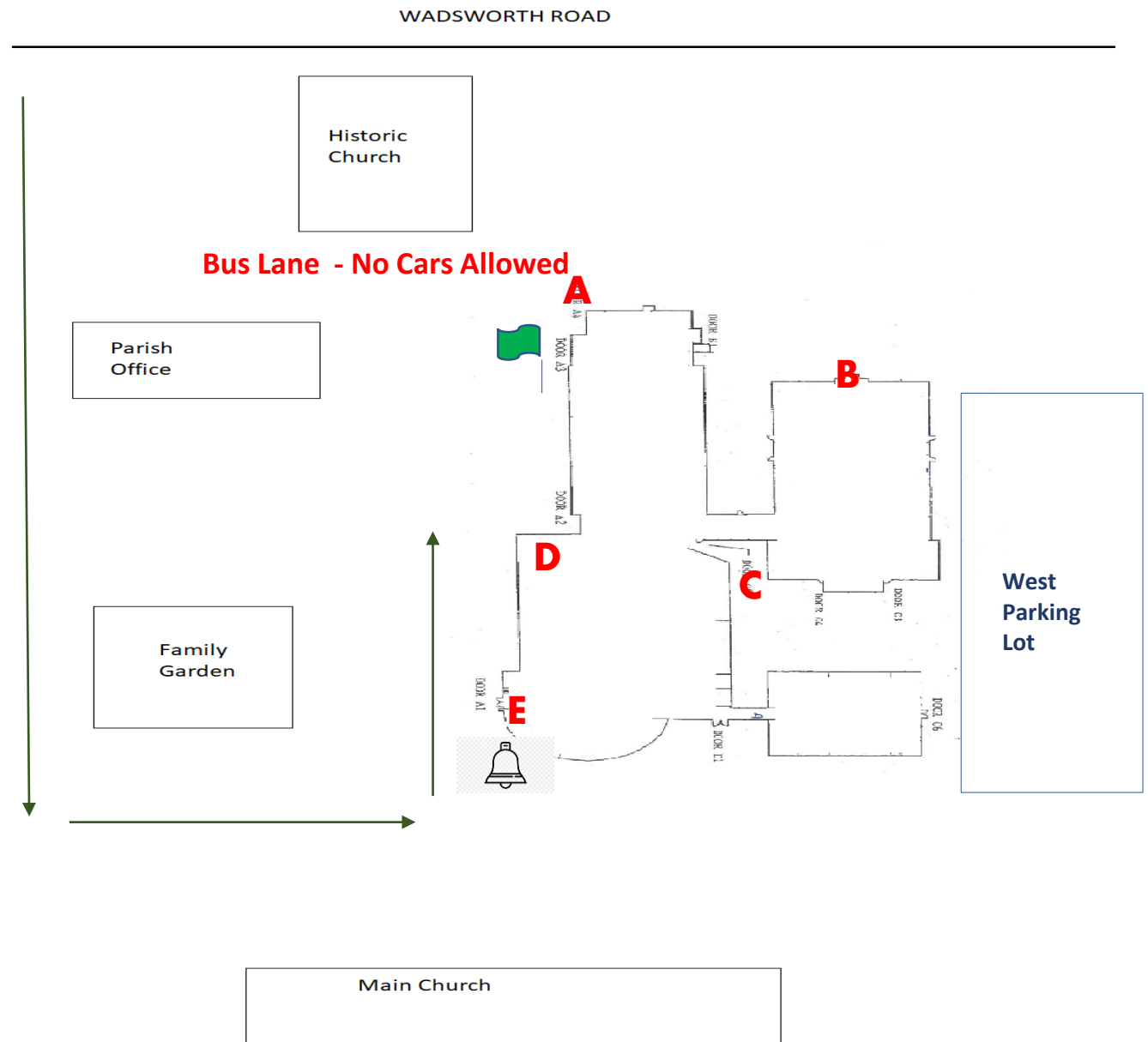

**IT IS ILLEGAL TO USE A CELL PHONE WHILE DRIVING IN A SCHOOL ZONE.
WE ALSO ASK YOU DO NOT USE THEM WHILE WALKING IN THE PARKING LOT**

Dismissal Procedures:

2:45pm – 3:00pm

- You must have your dismissal card to pick up. If you need a new one, please park and come to the office.
- Park in all parking spaces available, except for those marked in **orange**.
 - Those spots are reserved for parents picking up with young or sleeping children.
 - Place your dismissal card in your windshield and your student will be brought out to your car.
 - Do not leave engine running** if you back into those spaces. Parents/children are waiting in line on that sidewalk and will breathe the fumes.
- Enter school through (E) Stage Entrance. Your students name will be called. You will meet them as you walk around the gym. Please wait in the hub★
- Exit via the (D) Boehm Doors
 - Please follow instructions of our traffic attendants

3:01pm

- Please come to the office to pick up your student

Innovation Learning

Pick up at (C) Dyer Hall Entrance

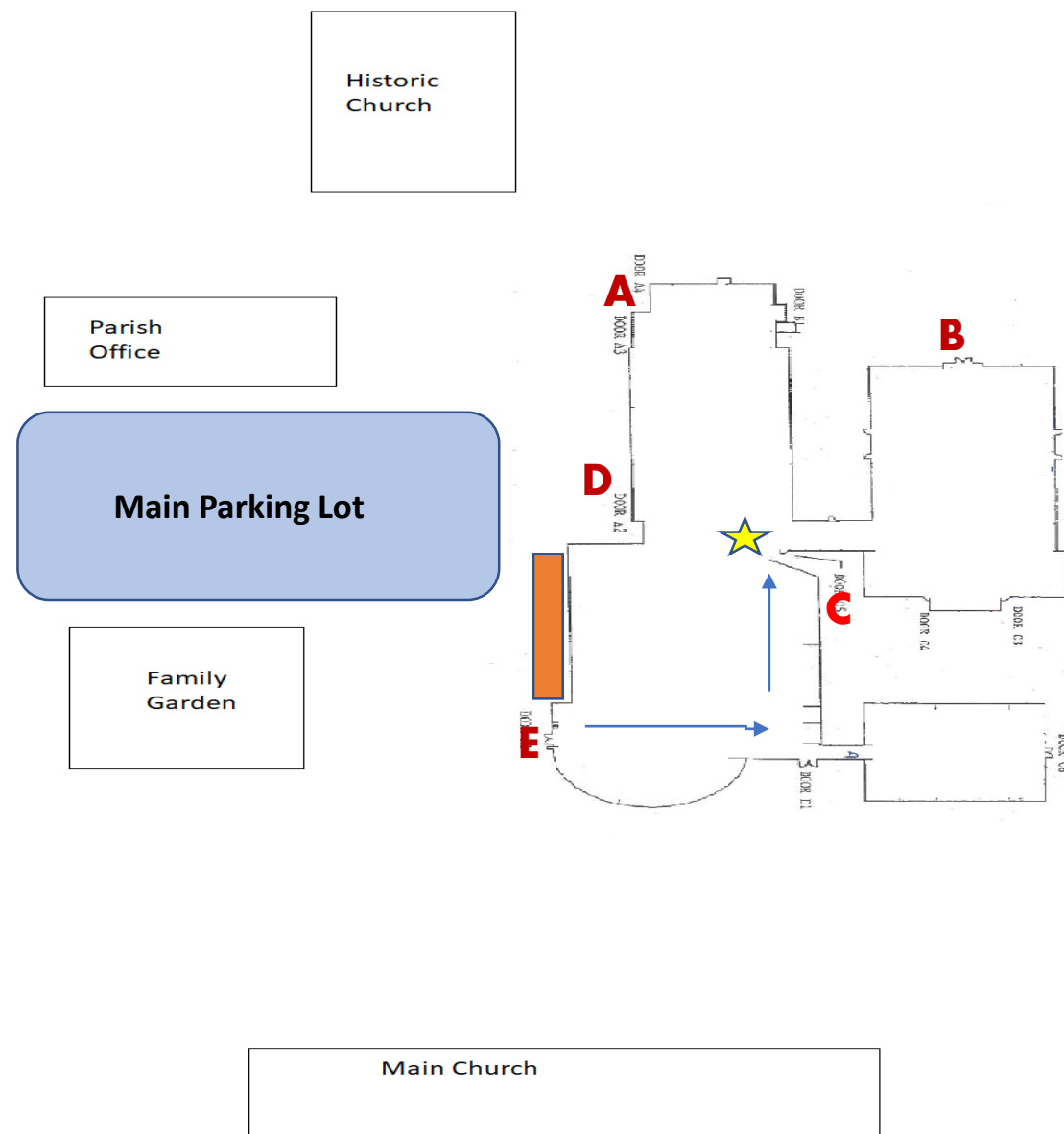

**IT IS ILLEGAL TO USE A CELL PHONE WHILE DRIVING IN A SCHOOL ZONE.
WE ALSO ASK YOU DO NOT USE THEM WHILE WALKING IN THE PARKING LOT**

Other Traffic Information

TRAVELING ON WADSWORTH ROAD

- If you are coming from the West on Wadsworth Road, you may enter the middle lane after you have passed Caroline Avenue if traffic is backed up.
 - The middle lane is **NOT A PASSING LANE** and the speed limit in that lane is 20 MPH only.
 - Other cars need to use the middle lane to turn from the eastbound lane. Please be aware of your surroundings
- There will be a Winthrop Harbor police officer near the school directing traffic. Please be sure to follow his direction.

PARKING DURING THE SCHOOL DAY

If you need to park on campus during the day, please use the lot east of the Historic Church first and then the west one once the east lot is full.

- The west lot is used by the Preschool parents each day.
- The main parking lot and west parking lots are closed during our recess times

LATE PICK UP

Supervision is provided until 3pm.

- Students will be sent to Innovation Learning if registered.
 - If you arrive after 3:00 PM your child will be sent to the AfterSchool Club program (if you are registered with them)
 - We encourage all families to sign up just in case of unplanned delays.

We understand that everyone runs late from time to time so we allow 2 emergency 'late pickups' (after 3pm) per year.

- If you have not signed up with Innovation Learning and you have used your 2 emergency days, you will then be charged a \$25 late fee on your FACTS account